

VERSO

HD LED DRAWER LIGHT

CODE: SE7300HDCW

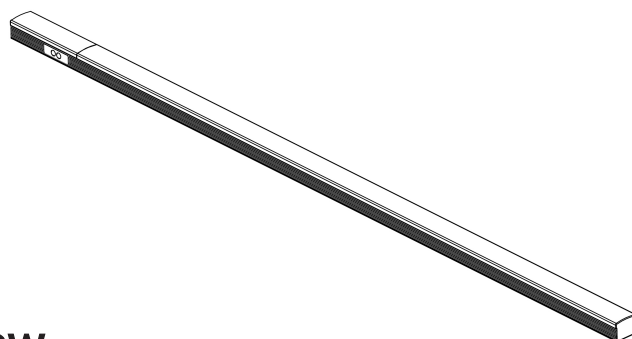

IMPORTANT: please read these instructions before commencing installation and retain for future reference.

Components

Tools required



1 x SE7500HD LED Touch Switch
Profile with 1.5m cable



2 x Screws

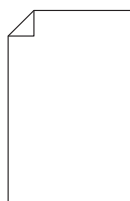

1 x Fitting Instructions



Pencil



10mm
Drill Bit



PZ1 Screw Bit

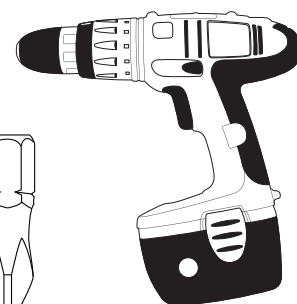

Power Drill

Important safety information

Please read these instructions carefully before attempting to install this product. It is advisable to keep these instructions in a safe place for further reference.

We recommend that you consult a qualified electrician. All electrical installations must be carried out in accordance with current IEE wiring regulations (BS7671).

These products must not be modified, if any modifications are made, it may invalidate the warranty and may render the product unsafe. These LED lights operate low voltage (12V).

Do not wire the individual LED light fittings directly to the mains. This product is for indoor use only. Keep out of moisture and use only in dry rooms.

- If in doubt installation must be carried out by a qualified electrician.
- Install on smooth flat surface(s) only.
- The Wattage of this product is 2W. Make sure that the LED driver used with these fittings has an adequate max wattage.
- We recommend using a SE40625 6W LED Driver with this fitting. You will be able to run a maximum of 3 fittings per driver.
- For more fittings, use the SE40525 15W 12V LED Driver. You will be able to run a maximum of 7 fittings per driver.

Safety instructions

1. Before commencing installation or maintenance, isolate the main electrical supply for the appropriate circuit at the fuse board.
2. This product requires a 12V LED driver which is only suitable for connecting to a 240V 50Hz supply.
3. The light should be mounted onto a secure surface.
4. Position lights where they will not be exposed to steam or splashes etc.
5. Suitable for furniture lighting.
6. When the lamp expires the fitting must be replaced.
7. Class III safety extra low voltage (SELV).

Waste Electrical & Electronic Equipment (WEEE)

The Symbol on the product, or on the document accompanying the product, the crossed out wheelee bin symbol, indicated that this product may not be treated as household waste. Instead it shall be handed over to the applicable collection point for the recycling of electrical and electronic waste.



RoHS ✓
Compliant



Installation

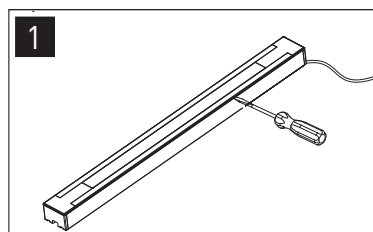

With a screwdriver or sharp object, carefully prise the light fitting from the housing.

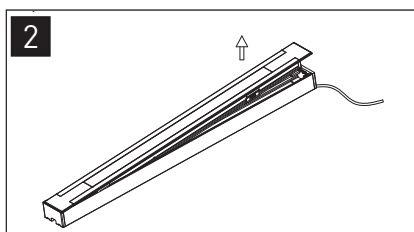

Take the fitting out.

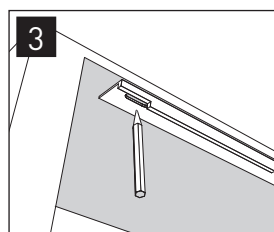

Mark-up the positions for the screw holes under the cabinet.

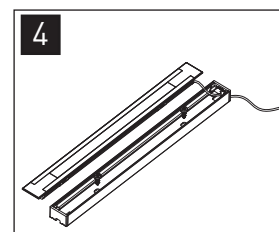

Using the screws provided, screw fix the housing in place.

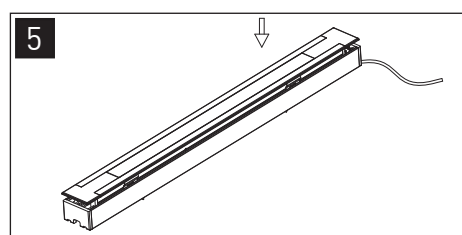

Place the fitting back into the housing.

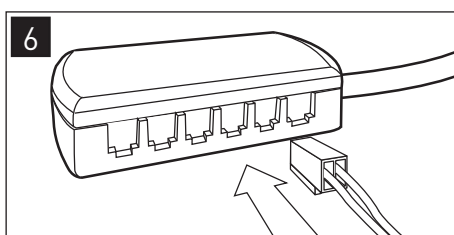

Plug the white connector into the 12V LED driver distributor block. Beware not to exceed the wattage of the LED driver, the max wattage will be displayed on the 12V LED driver and on the light unit fitting it will display the wattage requirement.

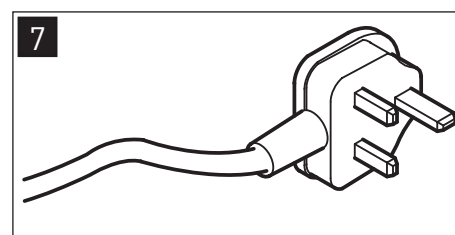

Finally wire the LED driver to 240V mains supply or 13A plug top.

Operation

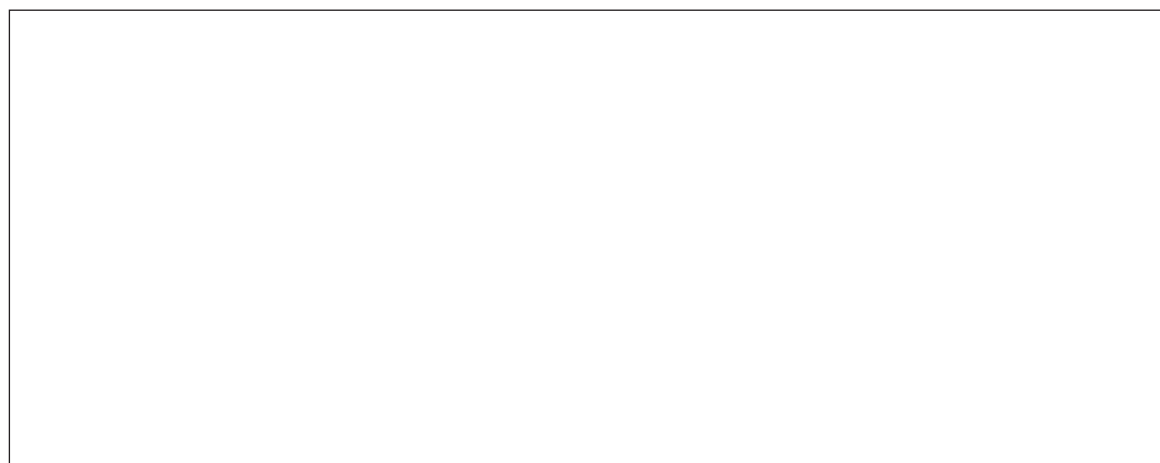

Once fixed the SE7500HD light is activated via the integrated on/off touch switch. The touch switch will illuminate blue as the fitting is switched on at the mains supply, touch the blue illuminated section of the fitting to switch the light on.

Maintenance & Care

- Ensure that the power is disconnected prior to cleaning.
- To keep the finish of this product, wipe over with soft cloth periodically.
- Do not use harsh chemical solvents, it may dis-colour or damage the finish.